

ESET Tech Center

Knowledgebase > Endpoint Solutions > ESET Endpoint Security > Create IDS exclusions on client workstations in your ESET endpoint product (7.x)

Create IDS exclusions on client workstations in your ESET endpoint product (7.x)

Anish | ESET Nederland - 2025-03-06 - Comments (0) - ESET Endpoint Security

Solution

ESET Security Management (ESMC) users: [Perform these steps in ESMC](#)

Create IDS exclusions on individual client workstations

1. [Open the main program window of your ESET Windows product.](#)
2. Press the **F5** key to access Advanced setup. Click **Network Protection** → **Network attack protection** and then click **Edit** next to **IDS exceptions**.



Figure 1-1

1. Click **Add**.



Fig 1-2

1. Select the **Alert**, type the **Remote IP address** (IP address of the machine with the software that scans the network).
2. In the **Action** section, select **No** from the drop-down menu. Click **OK** three times to save.

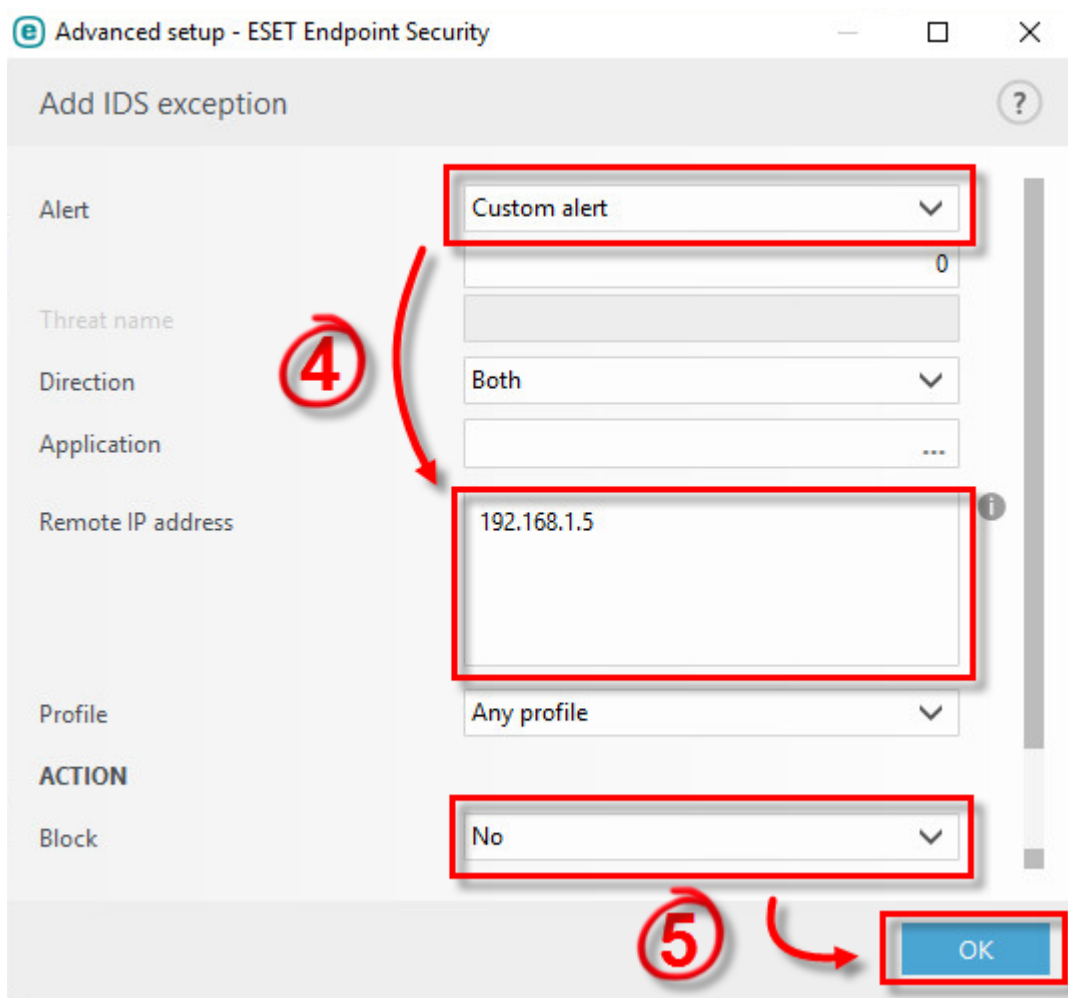

Figure 1-3

KB Solution ID: KB7053 | Document ID: 26424 | Last Revised: October 30, 2018

Tags
Exclusion
Uitsluiten